

SmallRig



(4850 / 4851)

Wireless Video Monitor for Phone (Vlog Kit)

Operating Instruction

Thank you for purchasing SmallRig's product.

Warnings

Please read this manual carefully.

This product is not dustproof or waterproof. Please do not use it in water. Protect the product from falling to the ground, collision or strong impact.

Product Description

Welcome to the SmallRig Mobile Phone Wireless Video Monitor. This kit provides a screen monitoring solution for content creation with mobile phones. The product includes a mobile phone monitor, a pan and tilt monitor mount or adsorption phone clamp, a Wireless remote controller, a charging cable, and other accessories. The monitor can be connected to device accessories such as mobile phone cages the pan and tilt monitor mount, and can also be directly attached to iPhones or other equipment with a MagSafe. When a user shoots at a low angle or needs to use the rear camera of his/her mobile phone, the monitor can mirror the phone.

In the Box

4850: Wireless Video Monitor for Phone

Monitor	× 1	Guarantee Card	× 1
Pan and Tilt Monitor Mount	× 1	Operating Instruction	× 1
Wireless Remote Controller	× 1	User Manual	× 2
Charging Cable	× 1		

4851: Wireless Video Monitor for Phone (Vlog Kit)

Monitor	× 1	Charging Cable	× 1
Phone Clamp	× 1	Guarantee Card	× 1
Phone Stand	× 1	Operating Instruction	× 1
Wireless Remote Controller	× 1	User Manual	× 2

Product Details

4850: Wireless Video Monitor for Phone

1. Monitor

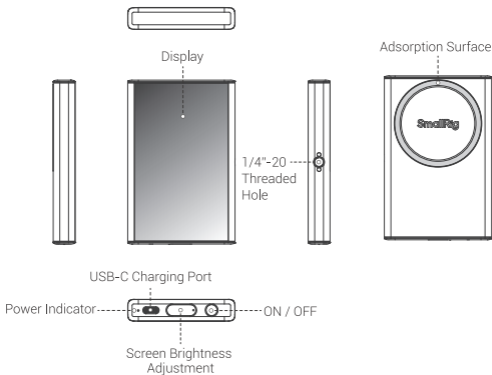

2. Pan and Tilt Monitor Mount



3. Wireless Remote Controller



Product Details

4851: Wireless Video Monitor for Phone (Vlog Kit)

1. Monitor

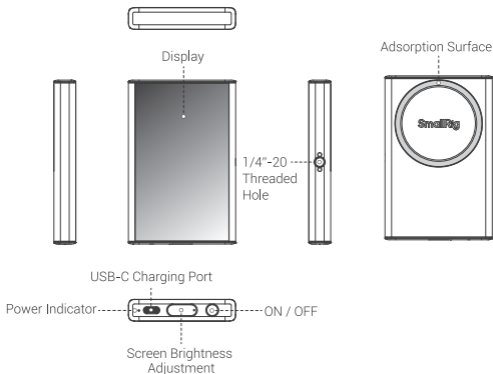

2. Phone Clamp + Phone Stand

This side is connected to the mobile phone.



This side is connected to the monitor.



3. Wireless Remote Controller



Kit Functions and Characteristics

1. **Real-time Screen Mirroring:** It can achieve 10 m WiFi direct wireless screen casting and mirrored switching.
2. **Quick Installation:** It can directly attach to iPhone12 and newer models as well as other phones equipped with a MagSafe.
3. **Compatibility:** It can be connected using standard 1/4"-20 threaded hole.
4. **Extended Standby Time:** The built-in 1,500 mAh cell can provide continuous power supply for 3h.
5. **Wireless Remote Control:** The wireless remote controller can be connected to the mobile phone for remote photography from up to 10m away.

Connect to iPhone

1. Long press the On / Off button for 3S to turn on.
2. Scan the QR code displayed on the screen with your iPhone camera, select "Connect" (enter the phone's WiFi menu, connect to "SmallRig monitor", and then enter the password 12345678).
3. Enable the "Screen Mirroring" of the mobile phone, and then click "SmallRig monitor".

Connect to Android

1. Long press the On / Off button for 3S to turn on.
2. Keep the WiFi on.
3. Pull down the control center, enable the "Mirror Casting" function, and select "SmallRig monitor".

Monitor Button Functions

1. **On / Off:** Long press the power button for 3S.
2. **Screen Mirroring:** Double-click the power button for switching, and double-click it again to exit the mirrored mode.
3. **Screen Brightness Adjustment:** Short press the brightness adjustment button to switch among three brightness levels.

Video Compatibility

1. **iPhone Camera:** Supports recording at 4K/24fps; there may be lag with 4K/30fps and higher.
2. **Blackmagic Camera App:** Compatible with all 4K recording options.

Device Installation and Removal

1. Attach the monitor to the magnetic gasket of mobile phone:

Directly attach the magnetic surface on the back of the monitor to iPhone 12 and newer models as well as other phones equipped with a MagSafe.

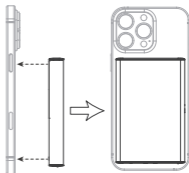

-
2. Attach the monitor to a cage or cold shoe interface:

Connect the monitor's built-in standard 1/4"-20 threaded hole to the compatible pan and tilt monitor mount, and then secure the cold shoe to the cold shoe interface on the cage.



-
3. Attach the monitor to a selfie stick:

Directly attach the magnetic surface on the back of the monitor to the magnetic gasket of the phone clamp, and then attach the phone to the clamp.

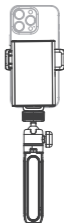

Monitor Parameters

Product Dimensions	106.0 × 69.0 × 14.0mm / 4.2 × 2.7 × 0.5in
Product Weight	129.0g / 4.5oz
Screen Dimensions	3.97inch
Screen Resolution	480 × 800px
Screen Brightness:	500cd/m ² (Max)
Wireless Network	WiFi 2.4G
Model	4850
Input	5V ^{max} 1A
Rated Power	1.65W
Battery Parameters	3.7V, 1500mAh, 5.55Wh
Power Port	USB-C
Working Temperature	-20°C to 48°C / -4°F to 118.4°F

FCC Statement

This equipment has been tested and found to comply with the limits for a Class B digital device, pursuant to part 15 of the FCC rules. These limits are designed to provide reasonable protection against harmful interference in a residential installation.

This equipment generates, uses and can radiate radio frequency energy and, if not installed and used in accordance with the instructions, may cause harmful interference to radio communications. However, there is no guarantee that interference will not occur in a particular installation. If this equipment does cause harmful interference to radio or television reception, which can be determined by turning the equipment off and on, the user is encouraged to try to correct the interference by one or more of the following measures:

- Reorient or relocate the receiving antenna.
- Increase the separation between the equipment and receiver.
- Connect the equipment into an outlet on a circuit different from that to which the receiver is connected.
- Consult the dealer or an experienced radio/TV technician for help.

To assure continued compliance, any changes or modifications not expressly approved by the party.

Responsible for compliance could void the user's authority to operate this equipment.

(Example: use only shielded interface cables when connecting to computer or peripheral devices).

This equipment complies with Part 15 of the FCC Rules. Operation is subject to the following two conditions:

- (1) This device may not cause harmful interference, and
- (2) This device must accept any interference received, including interference that may cause undesired operation.

RF warning statement:

The device has been evaluated to meet general RF exposure requirement.

The device can be used in portable exposure condition without restriction.

ISED Statement

English: This device contains licence-exempt transmitter(s) / receiver(s) that comply with Innovation, Science and Economic Development Canada's licence-exempt RSS(s). Operation is subject to the following two conditions:

- (1) This device may not cause interference.
- (2) This device must accept any interference, including interference that may cause undesired operation of the device.

French:Cet appareil contient des émetteurs/récepteurs exempts de licence qui sont conformes aux CNR exempts de licence d'Innovation, Sciences et Développement économique Canada. Le fonctionnement est soumis aux deux conditions suivantes :

- (1) Cet appareil ne doit pas causer d'interférences.
- (2) Cet appareil doit accepter toute interférence, y compris les interférences susceptibles de provoquer un fonctionnement indésirable de l'appareil.

This device meets the exemption from the routine evaluation limits in section 2.5 of RSS 102 and compliance with RSS 102 RF exposure, users can obtain Canadian information on RF exposure and compliance.

cet appareil est conforme à l'exemption des limites d'évaluation courante dans la section 2.5 du cnr - 102 et conformité avec rss 102 de l'exposition aux rf, les utilisateurs peuvent obtenir des données canadiennes sur l'exposition aux champs rf et la conformité.

This equipment complies with Canada radiation exposure limits set forth for an uncontrolled environment. This equipment should be installed and operated with minimum distance 0cm between the radiator & your body.

Cet équipement doit être installé et utilisé avec une distance minimale de 0cm entre le radiateur et votre corps.

Cet équipement est conforme Canada limites d'exposition aux radiations dans un environnement non contrôlé.

Manufacturer Email: support@smallrig.com

Manufacturer: Shenzhen Leqi Innovation Co., Ltd.

Add: Rooms 101, 701, 901, Building 4, Gonglianfuji Innovation Park, No. 58, Ping'an Road, Dafu Community, Guanlan Street, Longhua District, Shenzhen, Guangdong, China.

Consignor: Shenzhen LC Co., Ltd.

Add: Room 201, Building 4, Gonglianfuji Innovation Park, No. 58, Ping'an Road, Dafu Community, Guanlan Street, Longhua District, Shenzhen, Guangdong, China.



FCC ID: 2AZWI-4311LEQ1

FCC ID: 2BC2U-4850
CMIIT ID: 24J44G014850

RoHS



Points de collecte sur www.quefairedemesdechets.fr
Privilégiez la réparation ou le don de votre appareil !



Made in China

SmallRig



(4850 / 4851)

手机无线同屏器 (Vlog套装)

操作指引

感谢您购买SmallRig产品。

重要提示

- 请认真阅读本操作指引。
- 请勿在水中使用，本产品不具备防尘、防水功能。
- 请勿让产品掉落到地面、受到碰撞或强烈冲击。

产品简介

欢迎使用SmallRig 通用手机无线同屏器，本套件为手机内容创作提供屏幕监看方案。产品包含手机同屏器、无线遥控器、蜗牛云台或吸附手机夹套装、充电线等配件。同屏器可通过蜗牛云台与手机拓展框等设配连接，也可直接与iPhone以及支持吸附连接的设备进行快速连接。在用户使用手机进行低角度拍摄或需要使用手机后摄镜头拍摄时，同屏器可实时传输手机拍摄画面。

包装清单

4850: 手机无线同屏器

同屏器	× 1
蜗牛云台	× 1
无线遥控器	× 1
充电线	× 1
保修卡	× 1
操作指引	× 1
用户手册	× 2

4851: 手机无线同屏器 (Vlog套装)

同屏器	× 1
手机夹	× 1
手机支架	× 1
充电线	× 1
无线遥控器	× 1
保修卡	× 1
用户手册	× 2
操作指引	× 1

产品介绍

4850: 手机无线同屏器

1. 同屏器

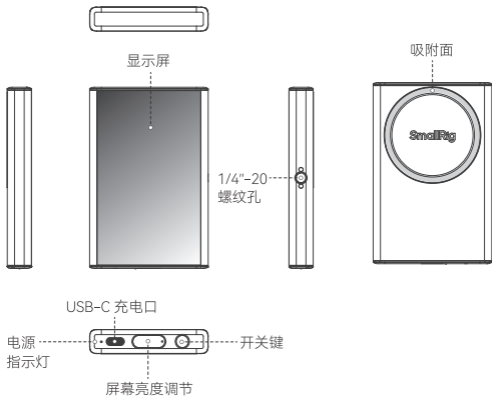

2. 蜗牛云台



3. 无线遥控器



产品介绍

4851: 手机无线同屏器 (Vlog套装)

1. 同屏器

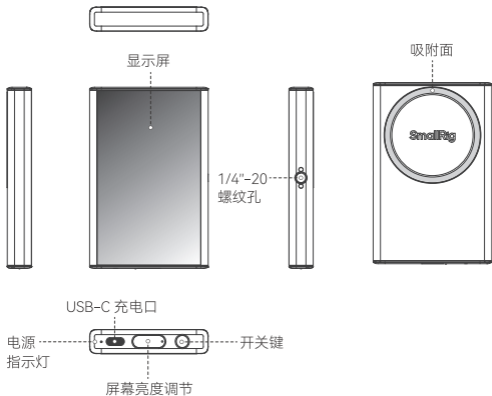

2. 手机夹 + 手机支架

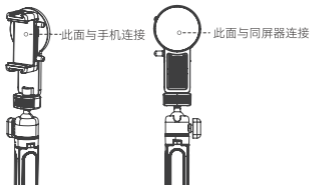

3. 无线遥控器



套件功能说明及特性

1. 实时屏幕共享：可实现10m WiFi Direct无线投屏以及镜像切换。
2. 快速安装：通过MagSafe直接吸附于带有吸附环或iPhone12及以上等手机。
3. 兼容性：标准1/4"-20 螺纹孔连接。
4. 超长待机：内置1500mAh电芯，可持续供电3h。
5. 无线遥控：无线遥控器可与手机实现10m连接远程拍照。

iOS 连接教程

1. 长按开关机3S，打开电源。
2. 打开iPhone相机扫描屏幕显示二维码，并选择连接(打开手机WiFi菜单栏，连接“SmallRig monitor”，密码12345678 进行连接。
3. 打开手机“屏幕镜像”，选择“SmallRig monitor”点击进行投屏。

Android 连接教程

1. 长按开关机3S，打开电源。
2. 保持Android手机WiFi打开。
3. 下拉控制中心，打开“镜像投屏”功能，选择“SmallRig monitor”即可投屏。

同屏器按键功能说明

1. 开机/关机：长按电源键3S。
2. 屏幕镜像：快速双击电源键切换，再次双击可退出镜像模式。
3. 屏幕亮度调节：短按亮度调节按键可进行三档亮度调节。

视频兼容性

1. iPhone原相机：支持录制4K/24fps、4K/30fps 及以上会出现延迟。
2. Blackmagic Camera App：支持所有4K录制。

设备装取

1. 同屏器与手机吸附连接：

直接通过同屏器背部可吸附面与iPhone12及以上系列手机以及带有吸附环的手机吸附连接。

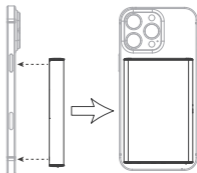

2. 同屏器与拓展框或冷靴接口等连接：

将同屏器内置标准1/4"-20 螺纹孔与搭配的蜗牛云台连接，再将冷靴底座固定至拓展框的冷靴口上。



3. 同屏器与自拍杆连接：

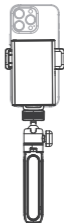

直接通过同屏器背部可吸附面与手机夹可吸附连接，手机夹与手机连接即可。



同屏器参数

产品尺寸	106.0 × 69.0 × 14.0mm
产品重量	129.0g
屏幕尺寸	3.97英寸
屏幕分辨率	480 × 800px
屏幕亮度	500cd/m ² (Max)
无线网络	WiFi 2.4G
型号	4850
输入	5V=1A
额定功率	1.65W
电池参数	3.7V, 1500mAh, 5.55Wh
电源端口	USB-C
工作温度	-20°C ~ 48°C

- a) Remove and immediately recycle or dispose of used batteries according to local regulations and keep away from children. Do NOT dispose of batteries in household trash or incinerate.
- b) Even used batteries may cause severe injury or death.
- c) Call a local poison control center for treatment information.
- d) The compatible battery type: CR2032.
- e) The nominal battery voltage: 3.0V DC.
- f) Non-rechargeable batteries are not to be recharged.
- g) Do not force discharge, recharge, disassemble, heat above (manufacturer's specified temperature rating) or incinerate. Doing so may result in injury due to venting, leakage or explosion resulting in chemical burns.
- h) Ensure the batteries are installed correctly according to polarity (+ and -).
- i) Do not mix old and new batteries, different brands or types of batteries, such as alkaline, carbon-zinc, or rechargeable batteries.
- j) Remove and immediately recycle or dispose of batteries from equipment not used for an extended period of time according to local regulations.
- k) Always completely secure the battery compartment. If the battery compartment does not close securely, stop using the product, remove the batteries, and keep them away from children.

 WARNING	
<ul style="list-style-type: none">• INGESTION HAZARD: This product contains a button cell or coin battery.• DEATH or serious injury can occur if ingested.• A swallowed button cell or coin battery can cause Internal Chemical Burns in as little as 2 hours.• KEEP new and used batteries OUT OF REACH of CHILDREN• Seek immediate medical attention if a battery is suspected to be swallowed or inserted inside any part of the body.	



Please refrain from disassembling the product. If there's any problem with the product, please contact the purchase platform for after-sales assistance.

请勿拆卸产品，如果您怀疑产品有任何问题，请联络购买平台，申请售后处理。

制造商: 深圳市乐其创新股份有限公司

地址: 中国广东省深圳市龙华区观澜街道大富社区平安路58号共联富基创新园4栋101、701、901

委托商: 深圳市乐长科技有限公司

地址: 中国广东省深圳市龙华区观澜街道大富社区平安路58号共联富基创新园4栋201

执行标准: GB4943.1-2022

LQ-P1420-18



FCC ID: 2AZWI-4311LEQI

FCC ID: 2BC2U-4850

CMIIT ID: 24J44G014850

Séparez les éléments avant de trier

RoHS



中国制造

Points de collecte sur www.quefairedemesdechets.fr
Privilégiez la réparation ou le don de votre appareil !